

ROADWAY DESIGN DIVISION

SEC. 26-T13N-R41W

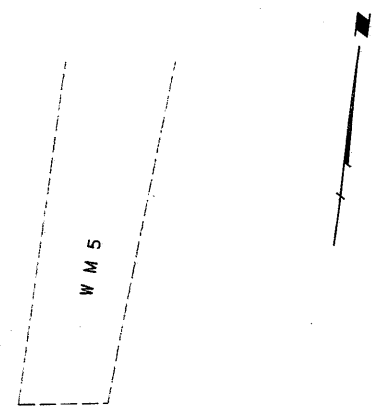

784 785 786 787 788 789 790

Computer: W-AMWIC-D-00037

User: Rottinghaus

Date: 10-SEP-2014 14:30

File: 615890cs06.dgn
Scale: 1:20

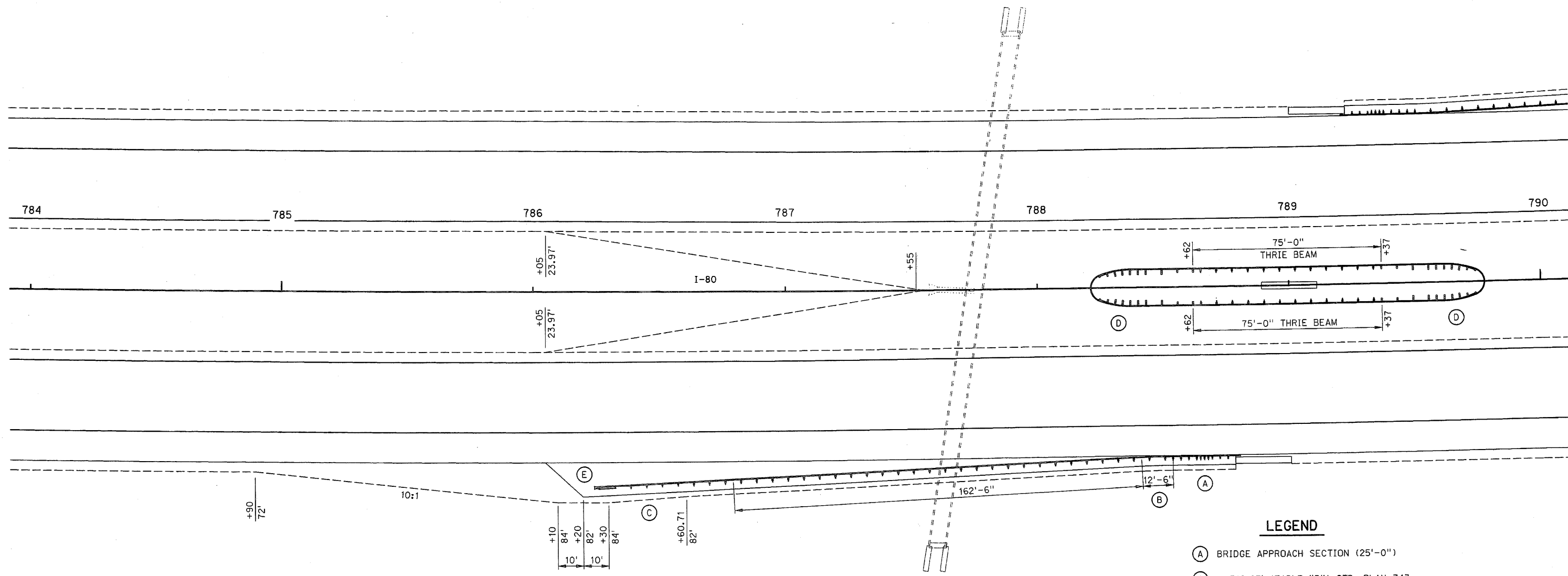

SEC. 26-T13N-R41W

NOTE: CONTRACTOR TO FIELD VERIFY
CONTROL BOLT LOCATIONS.

GUARDRAIL INSTALLATION AT STA. 789+00

UNDER BRIDGE #(S080 11185)

LEGEND

- (A) BRIDGE APPROACH SECTION (25'-0")
- (B) R=312.67' (TABLE "B") STD. PLAN 743
- (C) END TREATMENT, TYPE I (53'-1 1/2")
- (D) BULLNOSE - 12.5' (PARALLEL)
- (E) SURFACING UNDER GUARDRAIL
- (F) CONTROLLED RELEASING TERMINAL POSTS (CRT)
- GRADING LINE

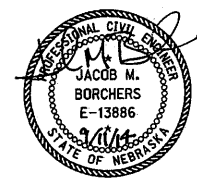

SHEET 6 OF 15

SPECIAL PLAN 7C

ROADWAY DESIGN DIVISION

Computer: W-AMWIC-D-00037

User: Rott+Inghaus

Date: 10-SEP-2014 14:30

File: 615890cs07.dgn
Scale: 1:20

SEC. 26-T13N-R41W

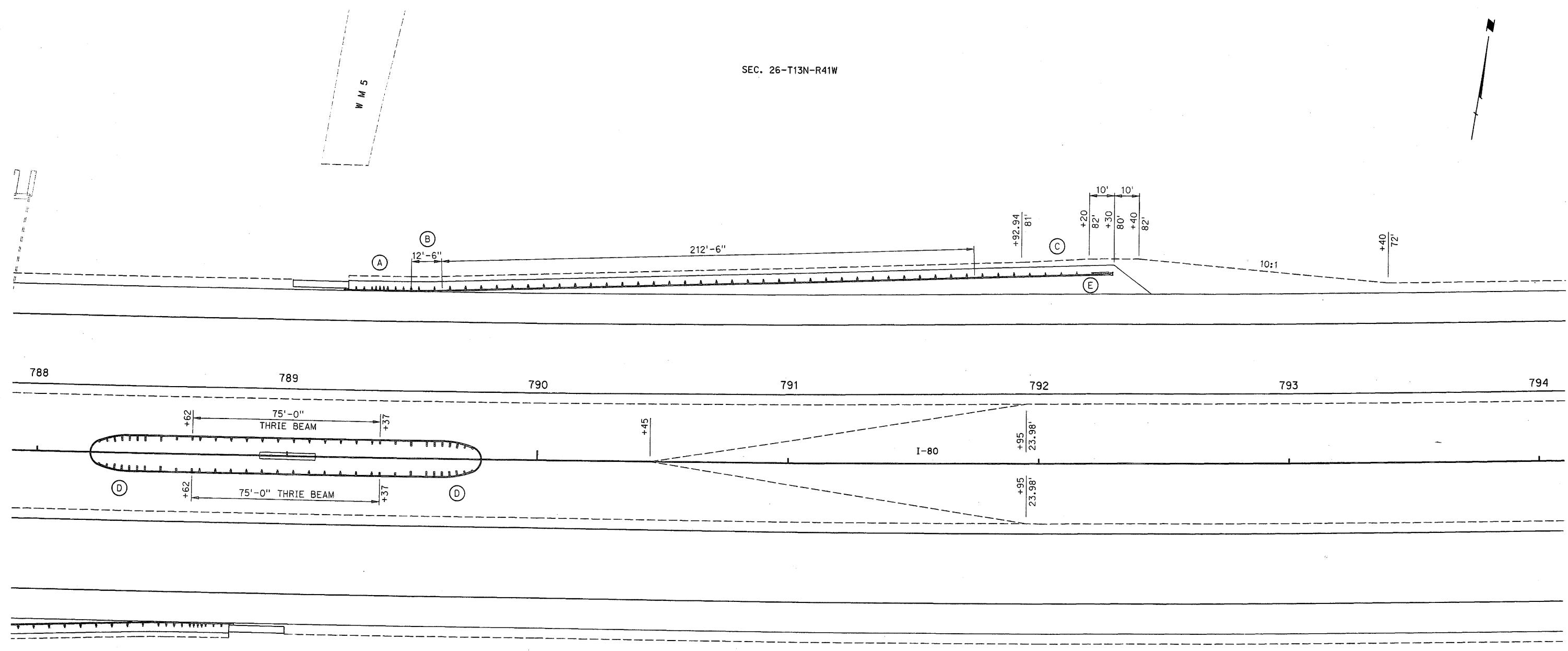

SEC. 26-T13N-R41W

NOTE: CONTRACTOR TO FIELD VERIFY CONTROL BOLT LOCATIONS.

GUARDRAIL INSTALLATION AT STA. 789+00
UNDER BRIDGE #(S080 11185)

LEGEND

- (A) BRIDGE APPROACH SECTION (25'-0")
- (B) R=312.67' (TABLE "B") STD. PLAN 743
- (C) END TREATMENT, TYPE I (53'-1 1/2")
- (D) BULLNOSE - 12.5' (PARALLEL)
- (E) SURFACING UNDER GUARDRAIL
- (F) CONTROLLED RELEASING TERMINAL POSTS (CRT)
- GRADING LINE

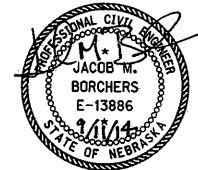

ROADWAY DESIGN DIVISION

Computer: W-AMWIC-D-00037

User: Rottinghaus

Date: 10-SEP-2014 14:30

File: 615890cs14.dgn
Scale: 1:20

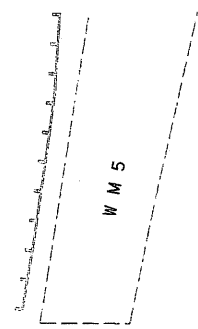

SEC. 26-T13N-R41W

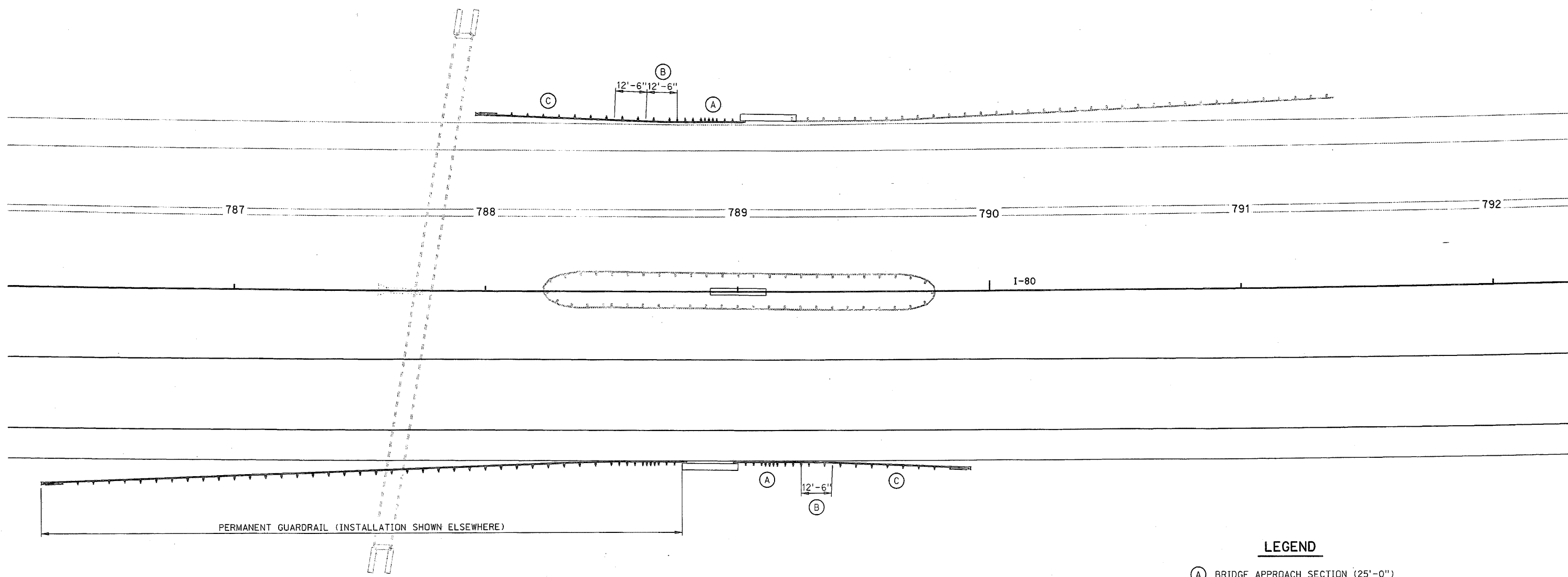

PERMANENT GUARDRAIL (INSTALLATION SHOWN ELSEWHERE)

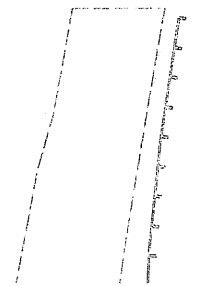

SEC. 26-T13N-R41W

NOTE: CONTRACTOR TO FIELD VERIFY CONTROL BOLT LOCATIONS.

TEMPORARY GUARDRAIL INSTALLATION AT STA. 789+00

UNDER BRIDGE #(S080 11185)

LEGEND

- (A) BRIDGE APPROACH SECTION (25'-0")
 - (B) R=312.67' (TABLE "B") STD. PLAN 743
 - (C) END TREATMENT, TYPE I (53'-1 1/2")
 - (D) BULLNOSE - 12.5' (PARALLEL)
 - (E) SURFACING UNDER GUARDRAIL
 - (F) CONTROLLED RELEASING TERMINAL POSTS (CRT)
- GRADING LINE

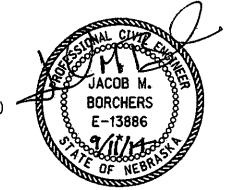

SHEET 14 OF 15

SPECIAL PLAN 7C