

ODOT NOTE: For uniform quantity calculations between systems, the length of this system is considered to be 53' - 1 1/2" measured from post 1 to the splice between posts 9 and 10.

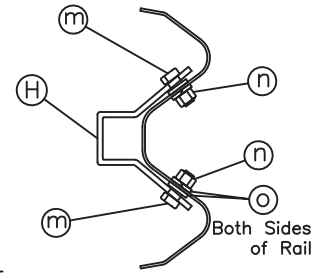
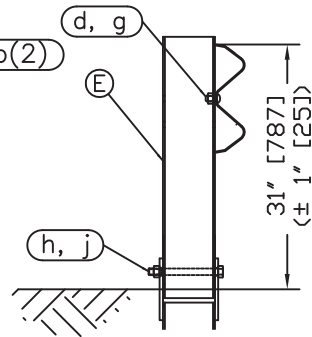
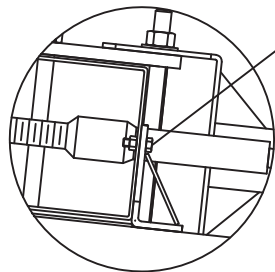
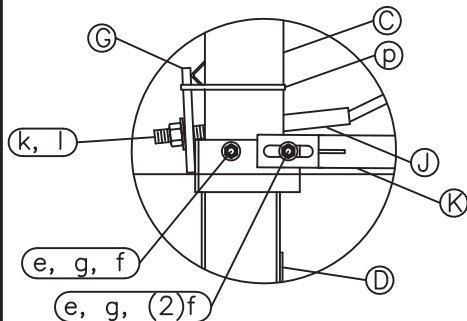
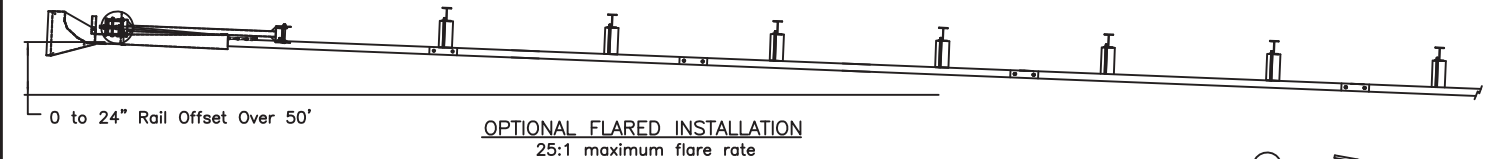

| ITEM | QTY | BILL OF MATERIALS | ITEM NO. |
|-------------------------------------|-----|----------------------------------------|-----------|
| A | 1 | IMPACT HEAD | MS3000 |
| B | 1 | W-BEAM GUARDRAIL END SECTION, 12 Ga. | SF1303 |
| C | 1 | FIRST POST TOP (6X6X1/8" Tube) | MTPHP1A |
| D | 1 | FIRST POST BOTTOM (6" W6X15) | MTPHP1B |
| E | 1 | SECOND POST ASSEMBLY TOP | UHP2A |
| F | 1 | SECOND POST ASSEMBLY BOTTOM | HP2B |
| G | 1 | BEARING PLATE | E750 |
| H | 1 | CABLE ANCHOR BOX | S760 |
| J | 1 | BCT CABLE ANCHOR ASSEMBLY | E770 |
| K | 1 | STRUT | MS785 |
| L | 6 | 6x9 (6x8.5) STEEL POST | P621 |
| M | 6 | RECYCLED PLASTIC BLOCK OR EQUIV. | P618 |
| N | 1 | W-BEAM MGS RAIL SECTION (9'-4 1/2") | G12025 |
| O | 2 | W-BEAM MGS RAIL SECTION (12'-6") | G1203A |
| HARDWARE (ALL DIMENSIONS IN INCHES) | | | |
| a | 2 | 5/16 x 1 HEX BOLT GRD 5 | B5160104A |
| b | 4 | 5/16 WASHER | W0516 |
| c | 2 | 5/16 HEX NUT | N0516 |
| d | 25 | 5/8 Dia. x 1 1/4 SPLICE BOLT (POST #2) | B580122 |
| e | 2 | 5/8 Dia. x 9 HEX BOLT A449 | B580904A |
| f | 3 | 5/8 WASHER | W050 |
| g | 33 | 5/8 Dia. H.G.R. NUT | N050 |
| h | 1 | 3/4 Dia. x 8 1/2 HEX BOLT GRD A449 | B340854A |
| j | 1 | 3/4 Dia. HEX NUT | N030 |
| k | 2 | 1 ANCHOR CABLE HEX NUT | N100 |
| l | 2 | 1 ANCHOR CABLE WASHER | W100 |
| m | 8 | 1/2 RSI SHOULDER BOLT W/WASHER | SB12A |
| n | 8 | 1/2 STRUCTURAL NUT | N012A |
| o | 8 | 1/2 STRUCTURAL WASHER | W012A |
| p | 1 | BEARING PLATE RETAINER TIE | CT-100ST |
| q | 6 | 5/8" x 14" H.G.R. BOLT | B581402 |

GENERAL NOTES:

- All bolts, nuts, cable assemblies, cable anchors and bearing plates shall be galvanized.
- The lower sections of the Posts 1&2 shall not protrude more than 4 in [100] above the ground (measured along a 5' [1.5m] cord longitudinal to the system). Site grading may be necessary to meet this requirement.
- The lower section of the hinged post should not be driven with the upper post attached. If the post is placed in a drilled hole, the backfill material must be satisfactorily compacted to prevent settlement.
- When competent rock is encountered, a 12" [300] Ø post hole, 20 in. [500] deep cored into the rock surface may be used if approved by the engineer for Posts 1 and/or 2. Granular material will be placed in the bottom of the hole, approximately 2.5" [60] deep to provide drainage. The first and/or second post can be field cut to length, placed in the hole and backfilled with suitable backfill. The soil plate may be trimmed if required.
- The breakaway cable assembly must be taut. A locking device (vice grips or channel lock pliers) should be used to prevent the cable from twisting when tightening nuts.



| | | |
|------------------------------------------------------|--|-------------------|
| MSKT-SP-MGS Terminal (12" Blocks) Test Level 3 | | Sheet: 1 |
| Drawing Name: MSKT-SP-MGS12 | | Date: 05/20/17 |
| Scale: None | | By: JRR |
| | | Rev: 0 |