

W152x13.4 steel posts, 946-mm long with 152x203x356 routed wood blockouts  
 BOLTONVILLE DIMENSIONS

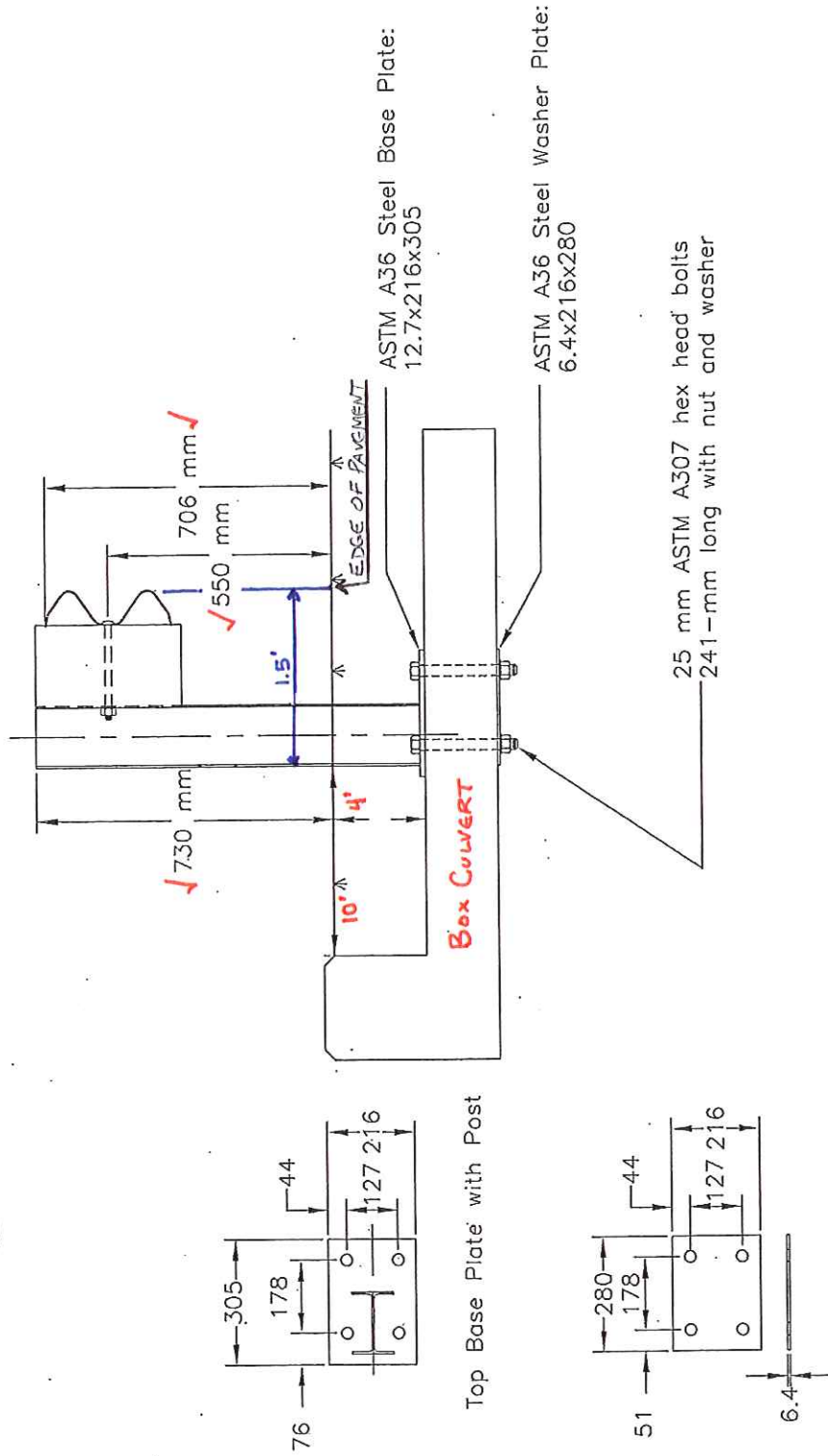

Note: Post 21 must be epoxied due to interference with culvert support.

Figure 32. W-Beam Guardrail Attached to a Low-Fill Culvert Post Nos. 15 through 27 (Option No. 1)



