

B13 Coil Nut and B25 Heavy Coil Nut

Dayton Superior B13 Coil Nuts and B25 Heavy Coil Nuts are available with coil threads in 1/2", 3/4", 1", 1-1/4" and 1-1/2" diameters. These nuts are available with right hand or left hand threads.

Coil Nut Type	Dia.	Approx. Height	Width Across Flats A	Safe Working Load Tension (lbs.)	
				Using One B13 Nut	Using Two B13 Nuts or One B25 Heavy Nut
B13	1/2"	7/16"	7/8"	6,000	9,000
B25	1/2"	1-3/16"	1-1/8"	—	9,000
B13	3/4"	5/8"	1-1/8"	9,000	18,000
B25	3/4"	1-3/16"	1-1/8"	—	18,000
B13	1"	1"	1-5/8"	24,000	38,000
B25	1"	2"	1-3/8"	—	38,000
B13	1-1/4"	1-1/4"	2"	36,000	56,000
B25	1-1/4"	2-1/2"	2"	—	56,000
B13	1-1/2"	1-1/2"	2-3/8"	47,500	68,000
B25	1-1/2"	3-3/8"	2-3/8"	—	68,000

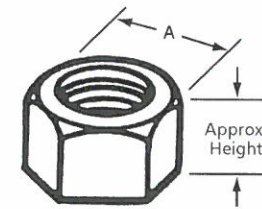

B13 Standard Coil Nut

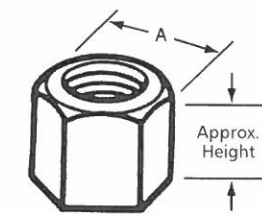

B25 Heavy Coil Nut

To Order:
Specify: (1) quantity, (2) name, (3) bolt diameter.

Example:
200 pcs. B13 Coil Nut, 3/4".

SWL provides a factor of safety of approximately 2 to 1.

Coil Nut Type	Dia.	Approx. Height	Width Across Flats A	Safe Working Load Tension (lbs.)	
				Using One B13 Nut	Using Two B13 Nuts
B13	1/2"	39/64"	7/8"	9,000	18,000
B13	3/4"	55/64"	1-1/4"	18,000	36,000

Medium/Heavy Forming Products

B14 Coil Bolts

Dayton Superior B14 Coil Bolts are designed for ease of use and durability. Coil bolts have fast acting, self-cleaning coil threads. B14 Coil Bolts may be fabricated from B12 Coil Rod with welded B13 Coil Nut heads.

Coil bolts are designed to be reusable, but they do wear and must be continuously inspected and replaced when wear or damage is noted. A waterproof grease should be applied to the portion of bolt that will be embedded in the concrete. This will facilitate bolt removal from the set concrete.

Minimum Coil Penetration Information

When determining the minimum required overall length of coil bolts, you must consider the following items:

- Formwork grip (including washer thickness).
- Setback of the form tie or insert.
- Minimum coil penetration (applies to all coil products).

See B14 Coil Bolt Selection and Minimum Coil Penetration Chart.



B14 Coil Bolt

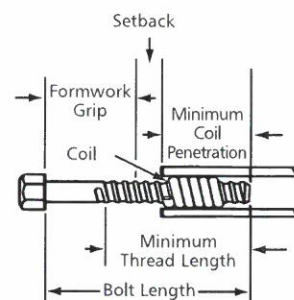

To Order:
Specify: (1) quantity, (2) name, (3) bolt diameter, (4) length of bolt.

Example:
500 pcs. B14 Coil Bolt, 3/4" diameter, 12" long.

B11 Flat Washers

Dayton Superior B11 Flat Washers are made from flat steel plate and are available in the sizes shown in the accompanying chart. For best results, the space spanned by the washer should not exceed the bolt diameter plus 1/4".

Bolt Diameter	Type	Safe Working Load (lbs.)	Size
1/2"	Standard	6,750	3" x 4" x 1/4"
1/2"	Heavy	8,750	4" x 5" x 1/4"
3/4"	Standard	6,750	4" x 5" x 1/4"
3/4"	Heavy	14,000	5" x 5" x 3/8"
1"	Standard	18,500	5" x 5" x 1/2"
1"	Heavy	38,000	7" x 7" x 3/4"
1-1/4"	Standard	22,750	5" x 5" x 1/2"
1-1/4"	Heavy	50,750	7" x 7" x 3/4"
1-1/2"	Standard	26,250	5" x 5" x 3/4"
1-1/2"	Heavy	41,500	7" x 7" x 3/4"

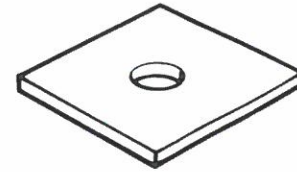

B11 Flat Washer

To Order:
Specify: (1) quantity, (2) name, (3) bolt diameter.

Example:
1,200 pcs. B11 Standard, 1/2" bolt.

SWL provides a factor of safety of approximately 2 to 1.

B12 Coil Rod

Dayton Superior B12 Coil Rod is available in 1/2" to 1-1/2" diameters in 12' lengths. Field cutting can be accomplished with bolt cutters or carborundum blades.

B12 threaded rod can be used with Coil Ties in many forming combinations to tie formwork, for adjustable ties, for concrete embedments and/or emergency ties.



B12 Coil Rod

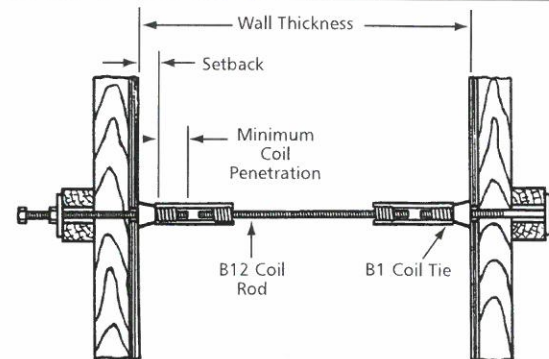

Coil Rod Diameter	Safe Working Loads		Minimum Root Area (sq. in.)	Tensile Stress (psi.)	Yield Stress (psi.)	Minimum Coil Penetration	Thread per inch
	Tension (lbs.)	Shear (lbs.)					
1/2"	9,000	6,000	.1385	130,000	110,000	2"	6
5/8"	12,000	8,000	.2124	113,000	96,000	2-1/4"	5
3/4"	18,000	12,000	.3079	117,000	100,000	2-1/4"	4.5
7/8"	24,000	16,000	.4477	117,000	100,000	2-1/2"	4.5
1"	38,000	25,300	.5410	140,000	120,000	2-1/2"	3.5
1-1/8"	46,000	30,000	.7163	126,600	105,000	2-1/2"	3.5
1-1/4"	56,000	37,500	.9161	123,000	105,000	2-1/2"	3.5
1-1/2"	68,000	45,300	1.3892	98,000	85,000	3"	3.5

SWL provides a factor of safety of approximately 2 to 1.

Warning: See working load info in General and Technical Information before using B12 Coil Rod.

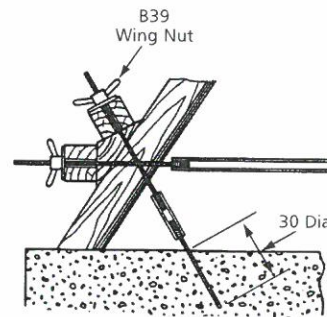

To Order:
Specify: (1) quantity, (2) name, (3) diameter, (4) length.

Example:
500 pcs. B12 Coil Rod, 1" diameter x 12'-0" long.

B17 Double Flared Coil Loop Insert

Dayton Superior B17 Double Flared Coil Loop Insert is made with two looped wire struts welded to a helix coil. The B17 insert is suitable for heavy form anchorage in mass concrete construction. Standard length is 12" for 1", 1-1/4" and 1-1/2" diameter units. Standard 6" nominal flares are supplied unless special size or shaped flares are requested.

Bolt Diameter x Insert Length	Flare width	Wire Strut Diameter	Safe Working Load Tension (lbs.)	Minimum Concrete Strength (psi)	Minimum Edge Distance
1" x 12" Std.	5-3/4"	.375"	18,000	2,000	15"
1" x 12" Hvy.	5-3/4"	.442"	27,000	2,000	15"
1-1/4" x 12" Std.	6"	.375"	18,000	2,000	15"
1-1/4" x 12" Hvy.	6"	.442"	27,000	2,000	15"
1-1/2" x 12" Std.	6-1/4"	.375"	18,000	2,000	15"
1-1/2" x 12" Hvy.	6-1/4"	.442"	27,000	2,000	15"

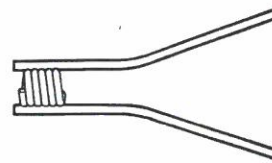
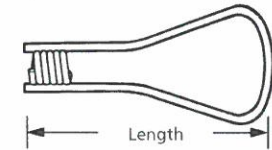

B17 Double Flared Coil Loop Insert

SWL provides a factor of safety of approximately 2 to 1.

SWL may vary with concrete weight and strength, as well as with insert setback and edge distance. Contact the Dayton Superior Technical Service Department for variables.

To Order:
Specify: (1) quantity, (2) name, (3) size, (4) SWL.
Example:
500 pcs. B17 Double Flared Coil Loop Inserts,
1-1/4" diameter, 27,000 lbs. SWL.

B18 Single Flared Coil Insert

Dayton Superior B18 Single Flared Coil Insert is made with the loop end flared for greater anchorage in the concrete. Standard lengths and sizes are shown in the chart. Special lengths and flare shapes can be special ordered.

To Order:
Specify: (1) quantity, (2) bolt diameter, (3) length, (4) SWL.

Example:
500 pcs. B18 Single Flared Coil Loop Insert, 3/4", 9", 7,500 SWL.

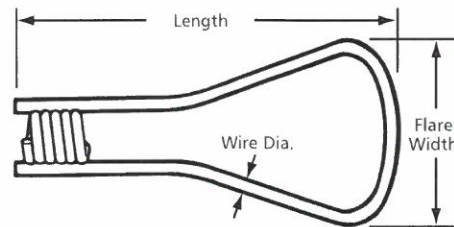

B18 Single Flared Coil Insert

Bolt Diameter x Insert Length	Flare width	Wire Strut Diameter	Safe Working Load Tension (lbs.)	Minimum Concrete Strength (psi)	Minimum Edge Distance
1/2" x 4" or 6" or 9"	3"	.223"	4,500	2,000	11"
3/4" x 6" or 9" or 12"	5-1/2"	.306"	7,500	2,000	13"
3/4" x 6" or 9" or 12"	5-1/2"	.375"	9,000	2,000	13"
3/4" x 9" or 12"	5-1/2"	.442"	13,500	2,000	13"
1" x 6" or 9" or 12"	5-1/2"	.375"	9,000	2,000	15"
1" x 9" or 12"	5-1/2"	.442"	15,000	2,000	15"
1-1/4" x 12"	5-1/2"	.375"	9,000	2,000	15"
1-1/4" x 12"	5-1/2"	.442"	15,000	2,000	15"
1-1/4" x 12"	5-1/2"	.442"	15,000	2,000	15"

SWL are based on 1/2" set back from face of concrete.

SWL provides a factor of safety of approximately 2 to 1.

SWL vary with concrete weight and strength as well as insert setback. For use in other than 2,000 psi normal weight concrete, contact technical services.

Medium/Heavy Forming Products

