

**DESIGN B**

DESIGN NO.	CURB WIDTH A	CURB HEIGHT H	CONCRETE	
			CU. YDS. PER LIN. FT.	LIN. FT. PER CU. YD.
B4	7-3/8"	4"	0.0294	34.0
B6	8"	6"	0.0352	28.4
B8	8-5/8"	8"	0.0414	24.2
B9	9"	9"	0.0449	22.3
B10	9-3/8"	10"	0.0485	20.6

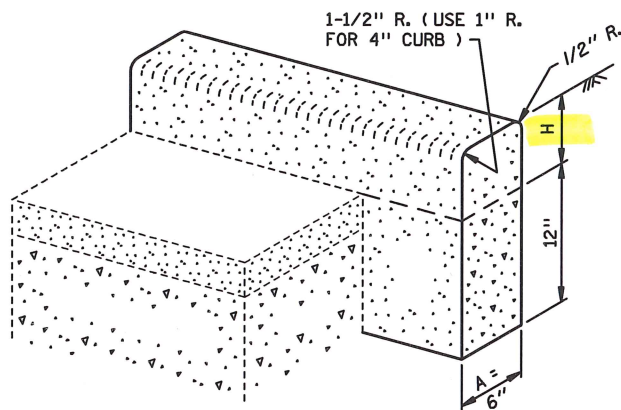

**DESIGN V**

DESIGN NO.	CURB HEIGHT H	CONCRETE	
		CU. YDS. PER LIN. FT.	LIN. FT. PER CU. YD.
V4	4"	0.0247	40.5
V6	6"	0.0277	36.1
V8	8"	0.0308	32.5
V9	9"	0.0323	31.0
V10	10"	0.0338	29.6

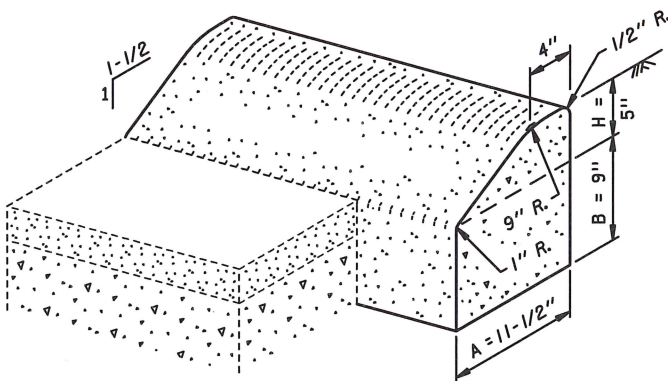

**DESIGN S**

DESIGN NO.	CONCRETE	
	CU. YDS. PER LIN. FT.	LIN. FT. PER CU. YD.
S5	0.0364	27.5

**NOTE:**

ALL CURB SLOPE MEASUREMENTS ARE IN RELATION TO ADJACENT PAVEMENT SLOPE.

APPROVED JULY 25, 2011

*[Signature]*  
STATE DESIGN ENGINEER

STATE OF MINNESOTA  
DEPARTMENT OF TRANSPORTATION

**CONCRETE CURB**

DESIGN B, DESIGN V, DESIGN S, DESIGN DR AND DESIGN BR

SPECIFICATION  
REFERENCE

2531

STANDARD  
PLATE  
NO.

**7020K**

1 OF 2

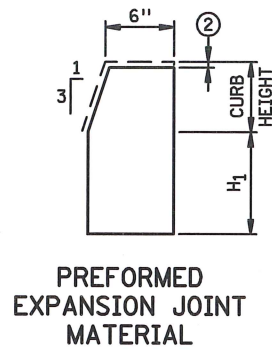
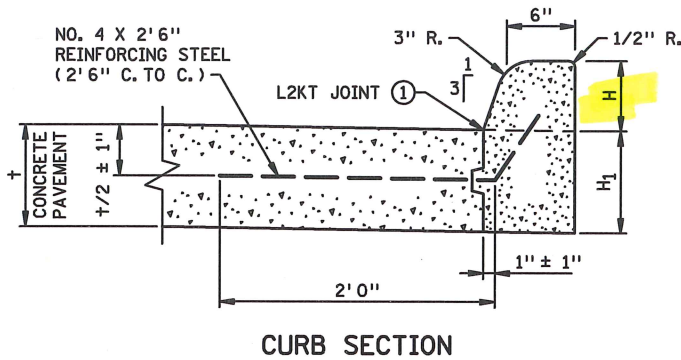

TABLE OF CU. YDS. PER LIN. FT. ③

DIMENSION H <sub>1</sub>	DIMENSION H					
	4"	6"	7"	8"	9"	10"
8"	0.0222	0.0275	0.0303	0.0332	0.0361	0.0392
9"	0.0240	0.0295	0.0324	0.0354	0.0384	0.0415
10"	0.0259	0.0315	0.0345	0.0375	0.0407	0.0439
11"	0.0277	0.0335	0.0366	0.0397	0.0429	0.0462
12"	0.0295	0.0355	0.0387	0.0419	0.0452	0.0486

**DESIGN BRH-H<sub>1</sub>**  
(EXAMPLE: DESIGN BR6-9)

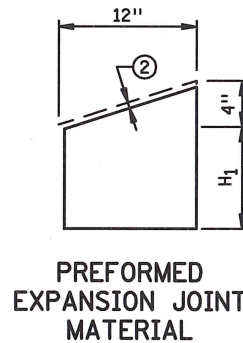
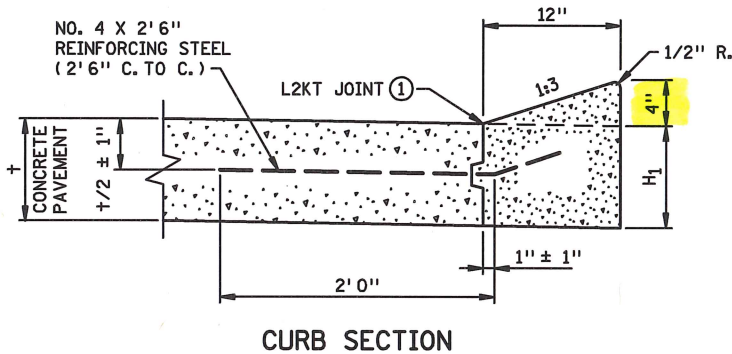
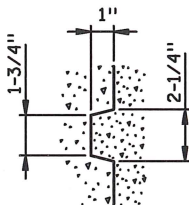

TABLE OF CU. YDS. PER LIN. FT. ③

DIMENSION H <sub>1</sub>	CU. YDS. CONC.
8"	0.0313
9"	0.0344
10"	0.0374
11"	0.0404
12"	0.0435

**DESIGN DR4-H<sub>1</sub>**  
(EXAMPLE: DESIGN DR4-9)



ALTERNATE KEYWAY DETAIL

NOTES:

ALL CURB SLOPE MEASUREMENTS ARE IN RELATION TO ADJACENT PAVEMENT SLOPE.

SEE STANDARD PLAN 5-297.221 FOR STANDARD PAVEMENT KEYWAY DETAIL.

JOINT MATERIAL SHALL BE OF 1/2" THICKNESS.

1 THICKNESS REQUIRED AT 1/2" EXPANSION JOINTS AND 3 THICKNESSES REQUIRED AT 1" EXPANSION JOINTS.

- ① SEE PLANS FOR SEALING REQUIREMENTS.
- ② 1/2" LESS THAN CURB DIMENSIONS FOR APPLICATION OF SEALER.
- ③ BASED ON A 2% PAVEMENT CROSS SLOPE AND STANDARD KEYWAY DESIGN.

APPROVED JULY 25, 2011

*[Signature]*  
STATE DESIGN ENGINEER

STATE OF MINNESOTA  
DEPARTMENT OF TRANSPORTATION

**CONCRETE CURB**

DESIGN B, DESIGN V, DESIGN S, DESIGN DR AND DESIGN BR

SPECIFICATION  
REFERENCE  
2531

REVISED  
3-22-2013 M.J.E.

STANDARD  
PLATE  
NO.

**7020K**  
2 OF 2